

REV.	DESCRIPTION	DRAWN	CHECKED	APPROVED
A	NEW RELEASE	LJH 04/27/05'	~	LJH 04/22/06'
B	ADD SCREW TYPE	DMJ 06/27/07'	~	LJC 06/27/07'
C	整理图面	YCH 05/21/08'	~	LJC 05/21/08'
F	ADD Pos TYPE	JLZ 03/29/16'	~	

NOTES:

- ELECTRICAL CHARACTERISTICS:
 - CONTACT RESISTANCE: 20mΩ Max. INITIAL.
 - DIELECTRIC WITHSTANDING VOLTAGE: 500V AC(rms) FOR 1 MINUTE.
 - INSULATION RESISTANCE: 1000MΩ Min.
- ENVIRONMENT CHARACTERISTICS:

TEMPERATURE RANGE: -40°C~+105°C.
- PART NUMBER: DS1034
- PRODUCT NUMBER CODE:

DS1034- X X X X X X X

 - SCREW DIM. A
 - S: Standard(W/O nut)
 - 1: 5.00 2: 3.00 3: 5.20
 - 4: 4.80 5: 5.80 6: 4.00
 - 7: 4.80mm(Inside thread M2.6*0.45p, outside thread unc#4-40)
 - 8: 4.80mm(Inside thread M3.0*0.5p, outside thread unc#4-40)
 - SCREW TYPE
 - S: Standard(W/O nut)
 - 1: CC TYPE 2: CS TYPE
 - 3: BR TYPE 4: BRJ TYPE DIM. B:6.00 C: 3~4mm
 - 5: BRJ TYPE DIM. B:6.00 C: 5~6mm
 - 6: BRJ TYPE DIM. B:6.00 C: 3~4mm (Inside thread M2.6*0.45P,outside thread unc#4-40)
 - 7: BRJ TYPE DIM. B:6.00 C: 3~4mm (Inside thread M3.0*0.50P,outside thread unc#4-40)
 - CONTACT PLATING
 - Si: FULL GOLD FLASH
 - 0: SELECTIVE GOLD FLASH
 - SHELL PLATING
 - T: FORNT & BACK SHELL TIN
 - N: FORNT SHELL NICKEL,BACK SHELL TIN
 - HOUSING COLOR
 - B: BLACK W: WHITE
 - U: BLUE
 - CONNECTOR TYPE
 - M: MALE F: FEMALE
 - No.OF CONTACTS
 - 09: 9pos. 15: 15pos. 25: 25pos.
 - 37: 37pos. 50: 50pos.

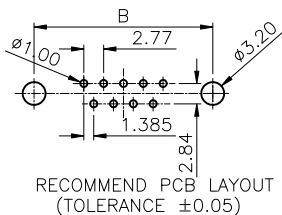
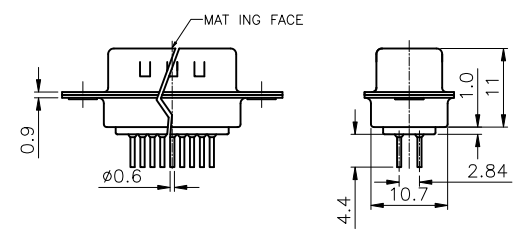
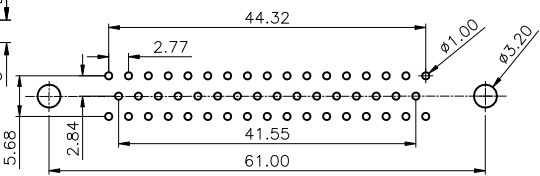
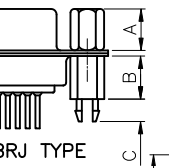
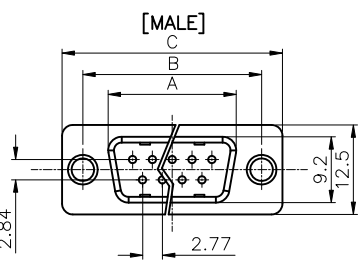
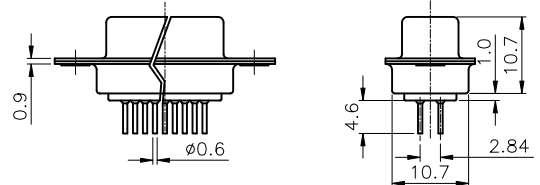
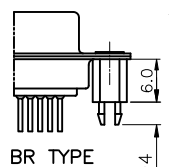
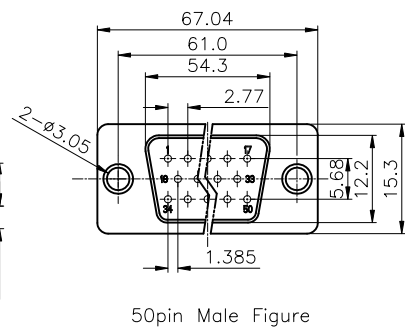
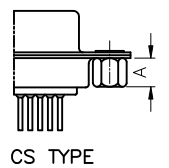
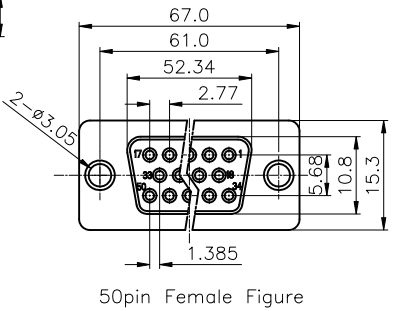
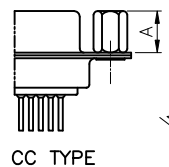
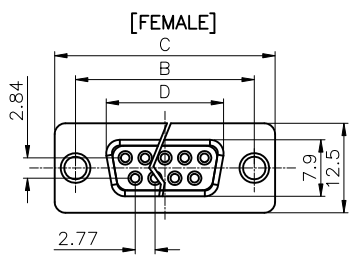
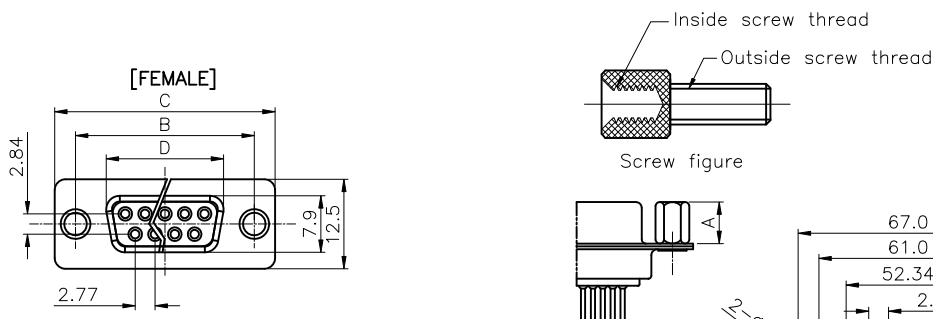

Dimension	Position	A±0.2	B±0.2	C±0.3	D
	9	17.90	24.99	30.80	16.33
	15	26.50	33.32	39.14	24.66
	25	40.00	47.04	53.04	38.38
	37	56.50	63.50	69.32	54.84

GENERAL TOLERANCE	ANGLE TOLERANCE
X. ±0.60	X. ±5°
.X ±0.38	.X ±3°
.XX ±0.25	.XX ±2°

PROJECTION	TITLE	D-SUB DIP STRAIGHT TYPE	
UNITS	mm	SHEET	DS1034 SERIES
SHEET SIZE	A4	SERIES	DS1034 SERIES

DRAWING TYPE	CUSTOMER
SCALE	1:1 SHEET 1 OF 1
DRAWING NO.	C-DS1034-XXXXXXX-F

晨翔电子有限公司
CONNFLY CONNFLY ELECTRONIC CO. LTD